

Mini Maintenance Kit

Part #:
PJ117MINI-H

D25F1 - 11 GPM
D25RE2 - 11 GPM



GENUINE
DOSATRON
PARTS

Instructions for
the D25RE2 on
the back

1-800-523-8499
www.dosatronusa.com



LIT-EN-PJ117MINI-H

Kit Contents:

MPDI122: Check
valve assembly



J051: Check
valve seal



DOSA-LUBE:
2.5 grams silicone



Use **Dosa-Lube** on
specified parts only.

J009:
Plunger seal



CAUTION: Parts may contain
concentrated chemicals. The use of
Proper Protective Equipment is recom-
mended when performing maintenance.



To remove seals easily without tools,
squeeze on either side to raise the seal,
then slide it over the groove. Using sharp
tools could damage the plunger.

Instructions for the D25F1

(Parts included in kit noted in **blue**)

Disassembly

1. Unscrew suction
hose nut (P153)
and remove suction
hose. Using a #2
Phillips screwdriver
remove the four
screws (M101) at
the base of the
unit. Remove collar
(M079).

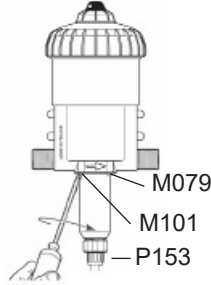

2. Pull the injection
stem assembly
(P439) down.

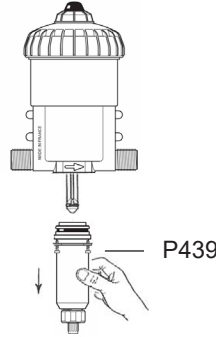

3. Remove old plunger
seal (J009) and
replace with new
seal in kit. If the
white cone
(PDI568) falls out
remember to reposition.

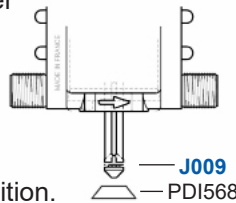

4. Unscrew the check valve
barb (P169). Remove
the check valve seal
(J051). If the seal
isn't visible at the
end of the injection
stem (P439), look
inside the check valve
barb (P169). Carefully
pry the check valve
assembly (MPDI122)
out of the injection
stem (P439) watching
out not to damage the
lower end of the
injection stem.



5. Insert the new check valve
assembly (MPDI122)
into the injection stem
(P439) with the cone
pointing out. Push the
new check valve
assembly as far as
possible into the stem.
Replace the check
valve seal (J051) into
the check valve barb
(P169) with the groove
facing up. Hand
tighten the check
valve barb (P169) onto
the injection stem
(P439). Rub small
amount of **Dosa-Lube**
on the stem o-ring
(J024).

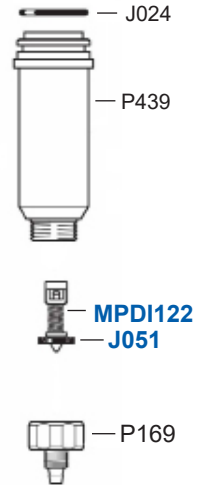

6. Insert the injection stem
assembly into the lower
housing. Align the
metal retainer plate with
the holes in the body
and using a #2
Phillips screwdriver,
carefully install the
four screws.

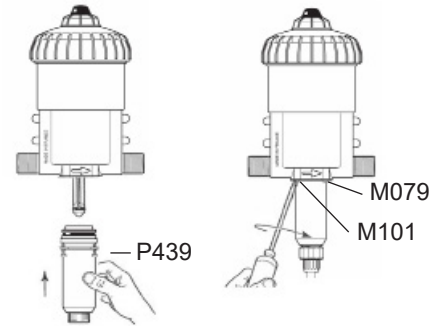

7. Cut 1" off from
the top of the
suction hose to
ensure a tight fit,
make sure to cut in
a straight line.
Reattach suction
hose and tighten
suction hose nut
(P153).

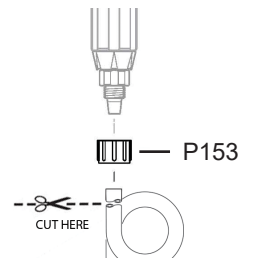

Mini Maintenance Kit

Part #:
PJ117MINI-H

D25RE2 - 11 GPM
D25F1 - 11 GPM



Instructions
for the D25F1
on the back

GENUINE
DOSATRON
PARTS

1-800-523-8499
www.dosatronusa.com

Kit Contents:

MPDI122: Check valve assembly



J051: Check valve seal



DOSA-LUBE:
2.5 grams silicone



Use **Dosa-Lube** on specified parts only.

J009:
Plunger seal



CAUTION: Parts may contain concentrated chemicals. The use of Proper Protective Equipment is recommended when performing maintenance.



To remove seals easily without tools, squeeze on either side to raise the seal, then slide it over the groove. Using sharp tools could damage the plunger.

Instructions for the D25RE2

(Parts included in kit noted in blue)

Disassembly

1. Unscrew suction hose nut (P153 or P150) and remove suction hose. Using a #2 Phillips screwdriver remove the four screws (M101) at the base of the unit. Remove collar (M079).

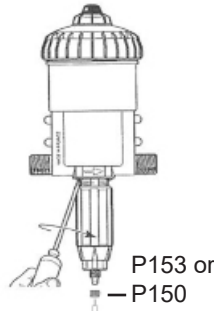

2. Pull the injection stem assembly (CD072) down.

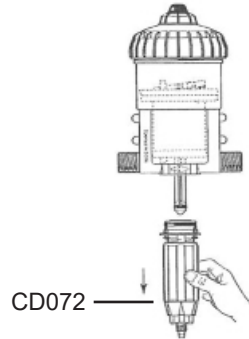

3. Unscrew the check valve barb (P169). Remove the check valve seal (J051) and discard. Unscrew the conical nut (P168), remove the anti-lock ring (P189) and carefully pry the check valve assembly (MPDI122) from the stem and discard.

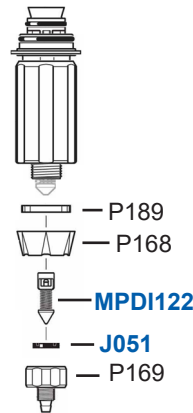

4. Remove the injection stem (PJ121) from the top of the injection sleeve (P165).

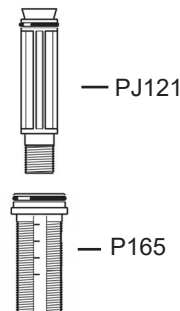

5. Insert the injection stem (PJ121) into the top of the injection sleeve (P165). Make sure that the long groove in the injection stem aligns with the tooth inside the injection sleeve.

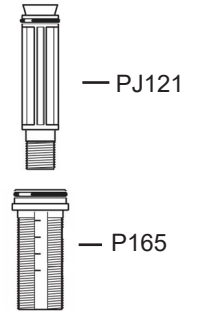

6. Reinstall the anti-lock ring (P189) and the conical nut (P168). Insert the new check valve assembly (MPDI122) into the injection stem with the cone pointing out, push it as far as possible into the stem. Position the check valve seal (J051) into the check valve barb (P169) with the groove facing up. Hand tighten the check valve barb. Set aside.

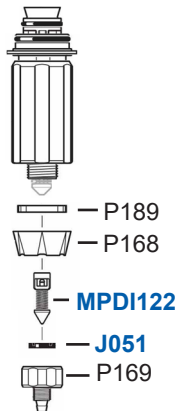

7. Remove and replace the plunger seal (J009). Reinsert injection stem assembly (CD072) into the body.

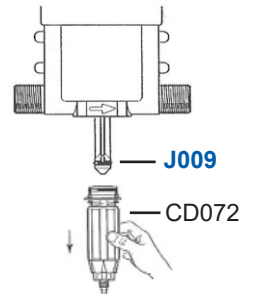

8. Align the metal collar (M079) with the holes in the body. Install the four screws using a #2 Phillips screwdriver.

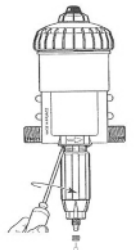

9. Cut 1" off from the top of the suction hose to ensure a tight fit, make sure to cut in a straight line. Slide suction hose nut (P153) onto the suction hose, reattach suction hose and tighten suction hose nut (P153).

